



M&M
golfestate[™]
Finest Golf Resort Living



About M3M

The Group, M3M stands for Magnificence in the Trinity of Men, Materials and Money.

The organization has a philosophy that strives for excellence culminating in absolute Magnificence in every aspect of its character, ethics and way of doing business. What the Group stands for is in sync with our slogan of "Our Expertise, Your Joy". The organization firmly believes in achieving brilliance through true professionalism and cutting edge technology.

The M3M Group is a conglomerate having a wide portfolio of real estate projects straddling ultra-luxury and premium residential complexes and innovative formats in commercial, hospitality, IT/SEZ and education. M3M Group owns prime land located right in the heart of Gurgaon, Delhi NCR.

Partnered with some of the most prominent and the best names of the industry.





Our Verticals



A Constant pursuit of joy in creation of a happy and networked residential society that is rewarding to the families and completely secure.



Forming prime commercial & retail spaces, most luxurious shopping destinations and the most sophisticated offices.



Establishing a global footprint through international associations and commendable tie-ups for technologically superior and world class infrastructure.



Redefining the aura of hospitality through unmatched services and unfathomable care to provide the utmost comfort and a fulfilling experience.



Developing the future, through world class and truly global workspaces for IT/ITES & SEZs.



Enhancing enlightenment of minds through holistic education and world class schools and institutions.

The M3M Life, a part of M3M Group's residential projects has always been versatile in its approach towards perfection. In the quest to present a flourishing premium lifestyle to the people of India, these apartment configurations range from well-planned and spacious duplexes to palatial 3 penthouses while keeping the needs and requirements of our customers in mind. Keeping our customers ease and comfort upfront, we made sure that all our projects are strategically located in Gurgaon's top residential sectors and in vicinity to the corridor that will connect Delhi with Gurgaon. Thus giving the best there can be a complete package.





Having your own
favourite sport as
your lifestyle





Having your own 9-hole
reversible Golf Course



That is what we call a
star studded luxury lifestyle







Golfing Lifestyle at par



Turn your favorite game into a way of life, a lifestyle that exudes class and luxury. These Golf themed residential condominiums offer its residents a multitude of amenities and lifestyle elements built around the residential apartments to ensure that a true golf connoisseur gets the perfect experience that lasts a lifetime.

Project is designed in such a way that every residential apartment and a majority of the common areas overlook the executive golf course designed by the world renowned **Graham Cook Associates**, while maintaining complete privacy.





Project Concept



Golf Estate brings India's first in-city 'Golf Resort' themed living experience to all golfing enthusiasts.

To ensure your presence amidst your admired sport, these apartments are rapt with luxury and are conceptualized on the lines of providing residences over 9-hole reversible golf course, thus providing each of these apartments the panoramic vistas of the beautiful executive golf course.





Site plan

Golf Course Extension Road
COMMERCIAL BELT



60 Meter Wide Road

Fairway
west

Fairway
east

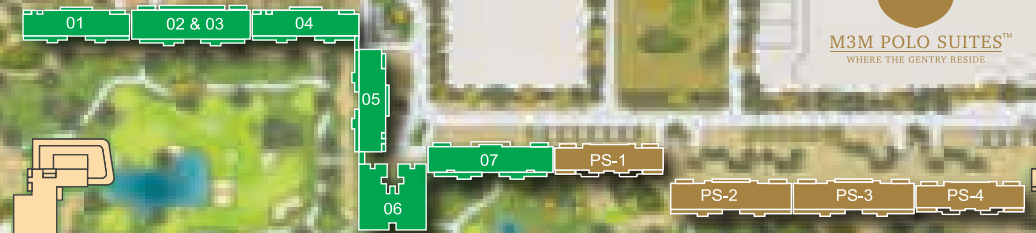
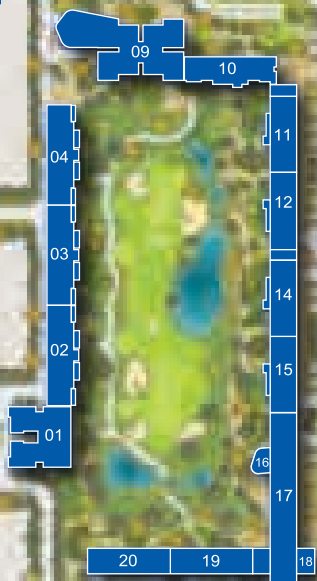

MASTERPLAN OF THE
MASTERPIECE!

SITE PLAN NOT TO SCALE



Grand Entrance



One of the most iconic entrances in Asia! Enter the world of luxury and grandeur hitherto unknown in the country.

The project offers a sense of magnificence through its contemporary design and an entrance which allows you to arrive in style through a palm lined grand entrance boulevard flanked with a steel turret sculptures.





Amenities and Lifestyle Elements



The towers offer well appointed tower drop offs, lavish lounge and lobby areas to your family and guests in the stilt area. The multiple community zones created within stilt level provide "All weather community areas" with landscaping and recreation zones including kids play areas, skating rinks, basketball courts, amphitheater, rock climbing, etc. These areas will act as a community zone to you and your family, and a spot for your neighbors to participate in social gatherings.

- 'Doctor-on-call' and Paramedical Services
- Exclusive concierge services
- Upmarket services and provision outlets
- International club facilities

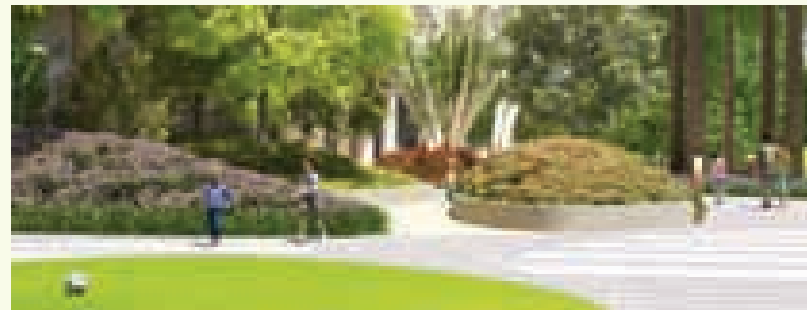



Amenities and Lifestyle Elements



- Landscaped rooftops and terraces for pampering your visual senses
- Rooftop Jogging track of 250 meters length





Resort Living at its Sportiest best



- An executive 9-hole golf course chip and putt spread over an expanse of lush greenery
- Verdant surroundings and water bodies to create a truly resort living experience

Sports amenities like tennis courts, badminton courts, swimming pools etc. spread out at multiple convenient locations across the project.





Enjoy a wonderful view
of the designer Golf Course
from every room



Exquisite Interiors



Living in a dream is no longer a myth. With spacious bedrooms and living rooms adorned with splendour, M3M Golf Estate is a **dreamer's paradise**.





Imperial Duplex



Indulge in opulence crafted with a consummate blend of panache and excellence. The quintessential duplexes will not only embrace your emotions but also add a befitting sense of charm to it. So, just relax and let life reinvent itself in such breath-taking golfing surroundings.





A Taste of Finesse



There is an air of a grand flair enthused in spaces where life will evolve. Each apartment has been planned to perfection. The interiors of each and every Golf Estate home have been magnificently painted with panache. The walls have been stroked with myriad hues of imagination.

Enjoy cooking in the artistically crafted kitchens decked with modern appliances. It is a haven for those who crave for **luxury on a platter**.





Majestic Penthouses



The ultimate statement of class and style—the most luxurious ‘TRIPLEX PENTHOMES’ in Asia. Set right up in the sky—almost perched in the stratosphere, it comes replete with an exclusive private infinity pool, pantry deck, three floors of sheer joy, richness personified.





Our Business Partners



Architectural Design

Architectural design by world's leading Architectural firm - **Arcop International, Montreal Canada**. Spearheaded by their chief architect Mr. Ramesh Khosla who's credited with landmark developments across the globe.

Landscaping Design

Landscaping by **GCH Planning & Landscape Architecture (Geyer Coburn Hutchins), USA**, world renowned leader of the new wave of landscape architecture with several award winning creations to their credit.

Interior Design

Interior designing by leading international firm **M/s BLD (Bilkey Llinas Design), USA**. BLD is a specialist in high-end hospitality related projects worldwide including hotels, resorts, casinos, country clubs, spas and convention facilities.

Structural Consulting

By LERA. **Leslie E Roberts and Associates (LERA), USA** has been associated with some of the best known structures in the world, like Shanghai World Finance Centre, 1 World Trade Centre (Freedom Tower), Nakheel Tall Tower, Sony Building, World Trade Centre etc. to name a few.

Golf Course Design

9-Hole Executive Golf Course designed by **Golf Plan, USA**; Golf Plan has been providing golf planning and design services across the globe for last 40 years & have numerous award winning golf course designs to their credit.

Iconic Club Design

Iconic club designed by **UHA (Upton-Hansen Architects), London**.

Execution

Execution of this one of its kind luxury Golf Living entrusted to **L&T**.

Lighting Experts

Landscape and Common area external lighting and Facade Lighting Consultants:

M/s Bo Steiber, Singapore.





M3M
golfestate™
Finest Golf Resort Living

MAP NOT TO SCALE

Location Map

SPLENDOR RESIDES IN SECTOR 65, GURGAON

Decked with world-class features and a plush lifestyle, M3M Golf Estate has already become the buzz of the Gurgaon urbanscape – the rapidly developing metropolitan that symbolizes modern India. The splendor of M3M Golf Estate promises to usher more prosperity to the satellite city and augment the standard of living in the region. The never-seen-before luxury residences will spearhead the magnificence in the length and breadth of the neighborhood. In a nutshell, the epitome of Gurgaon will soon be sector 65, courtesy M3M Golf Estate.

In Close Proximity to

-  Delhi International Airport
-  Metro Station
-  Medanta Hospital

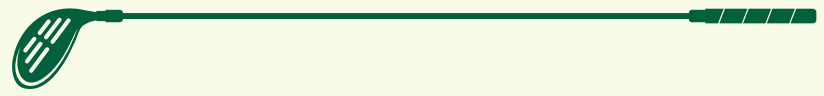

M3M GOLF ESTATE - SPECIFICATIONS

AREAS	FLOOR	WALLS/CEILING	DOORS & WINDOWS/GLAZING	OTHER
Master Bedroom/Other Bedrooms	Master Bedroom: Imported Marble/Engineered Wooden Flooring Other Bedrooms: Engineered Wooden Flooring	POP Punning with Acrylic Emulsion Paint on Walls & Ceiling	Doors: 2.4 meters High Flush Shutters with Polished Veneer Windows: Upvc/Aluminium Window Frames with Combination of Double/Single Glazed Panels	VRV/VRF AC Units
Kitchen	Natural Stone	Combination of Premium Tiles & POP Punning with Acrylic Emulsion Paint on walls Ceiling: Acrylic Emulsion Paint	Doors: 2.4 meters High Flush Shutters with Polished Veneer Windows: Upvc/Aluminium Glazings	Designer Modular Kitchen, Fully Fitted With Premium Brand Hob, Chimney, Dishwasher, Microwave Oven and Refrigerator. Granite Counter Top, Stainless Steel Sink Imported CP Fittings
Master Toilets & Other Toilets	Imported Marble	Master Toilet: Imported Marble Other Toilets: Premium Tiles False Ceiling with Acrylic Emulsion Paint	Doors: 2.4 meters High Flush Shutters with Polished Veneer Windows: Upvc/Aluminium Glazings	Master Toilet: 5 Fixture Toilet With Premium Quality Imported Chinaware, Bathtub with Jacuzzi. Other Toilet: 3 Fixture Toilet with Imported Chinaware Imported CP Fittings, Marble Counter, Glazed Shower Enclosure, Exhaust Fan Vented to Exterior. Mirror with Wall Mounted Vanity Lighting

AREAS	FLOOR	WALLS/CEILING	DOORS & WINDOWS/GLAZING	OTHER
Living Room/Dining/Foyer/ Family Room/Study	Imported Marble	POP Punning with Acrylic Emulsion Paint on Walls & Ceiling	Entrance Door: 2.4 meters High Flush Shutters with Polished Veneer and Polished Door Frame. Internal Doors: 2.4 meters High Flush Shutters with Polished Veneer Windows: Upvc/Aluminium Window Frames with Combination of Double/Single Glazed Panels	VRV/VRF AC Units
Utility/Servant Room	Ceramic Tiles	Oil Bound Distemper Paint	Doors: 2.4 meters High Flush Shutters with Polished Wood Veneer Windows: Upvc/Aluminium Glazings	Indian Chinaware and CP Fitting
Balcony/Terraces	Anti-Skid Vitrified Tile	Exterior Paint	Windows: Upvc/Aluminium Glazings	

Power Back-Up and CCTV Surveillance

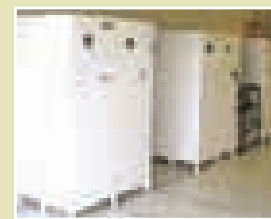

100% Power backup per apartment and treated water supply & all systems for fire safety as per norms.

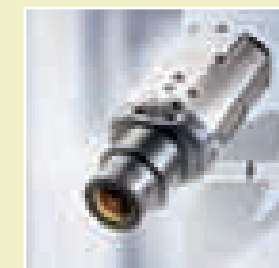

CCTV for basements, ground floor lobbies, entry and exit to the development. Automatic boom barriers and manual gates at entry and exits, intelligent access control system, panic alarm button is installed in master bedroom and a door phone near apartment entrance, connected to the security control room/ management office.

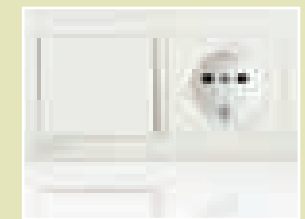

Premium modular switches & sockets, copper wiring.

Other Projects

RESIDENTIAL



SINGAPORE STYLE WORLD-CLASS APARTMENTS
The best of Singaporean lifestyle



WHERE THE GENTRY RESIDE
The royal lifestyle of the gentry,
blended with the royal game



Away from the crowd,
yet in the heart of Gurgaon



The best of architecture and
aesthetics surrounded by the Aravalli's

COMMERCIAL



The Latest in the Evolution of Urban Business & Retail
California Style retail-cum-office complex



STYLISH RETAIL & COMMERCIAL HUB
The grand ensemble of stylish
retail and commercial hub



A unique health experience and one stop
destination for all health care



The Workplace of the Future





M3M India Limited
(Erstwhile: M3M India Developer Limited)
CIN: U80903HR2007PLC044491

 Paras Twin Towers, Tower-B,
6th Floor, Golf Course Road, Sector-54,
Gurgaon - 122002, India

Sales Gallery/ CRM Cell
The Experia, Golf Course Road (Extn.),
Sector-65, Gurgaon - 122002, India

Site
M3M Golf Estate,
Golf Course Road (Extn.), Sector-65,
Gurgaon - 122002, India

 +91 124 4732000

 +91 124 4732010

 1800 123 3333

 'M3M' to 56263

 sales@m3mindia.com

 www.m3mgolfestate.com

Disclaimer: The information contained in this Brochure ("Brochure"), is merely informative and unless otherwise expressly provided, all contents are for general information purposes. Nothing contained herein intends to constitute an offer/ invitation to offer or sale. The reader hereby accepts and agrees to be bound by and comply with these legal terms of use.

This Brochure contains proprietary information, exclusive to the brand "**M3M**" or M3M India Limited ("Company"). All images on the Brochure, including text, photo's, illustrations, graphs, logos, trade and services brands, are fully owned by Company and are protected by copyright, trademark rights and other intellectual property rights under law. The contents, and any information or opinion on the Company's projects, products and business, may not be reproduced, transmit (by any means), modified, sold, circulated, shared or otherwise provided, in whole or in part, to any other person or entity store, archive or in any other way use for any public or commercial purpose without the Company's explicit consent. Company reserves its right to revoke any such consent, without prior notice Any unauthorized review, use, disclosure, dissemination, forwarding, printing or copying of any page, information, brochure or any action taken in reliance on the information is strictly prohibited and may be unlawful.

The Company does not warrant the completeness, accuracy, correctness of the information available herein and the readers are advised to verify any/ all information from the Company before claiming any reliance on it. The information and contents herein, including all designs, layouts, specifications, plans, services, facilities and infrastructure are illustrative and subject to government norms, and may be changed without notice. All areas and figures are indicative and the units mentioned herein are subject to availability. Further, the contents are subject to terms as stated in the Application Form and Buyer's Agreement. License No. 234 of 2007 dated 16/10/2007; 52 of 2009 dated 28/08/2009; and 35 of 2010 dated 06/05/2010 accorded to M/s Manglam Multiplex Pvt. Ltd. & ors. to develop a Group Housing Colony over 62.99 acres of Land. Building Plan Approval No. ZP-357/JD (BS)/ 2012/ 19471 dated 01.10.2012 (granted for existing development, subject to revision for future development). Total No. of Apartments 1722. Provision for community building, shops for convenient shopping, nursery school, primary school and other amenities as per approved plans, and subject to conditions. Copies of approvals are available for inspection at Developer's office at Paras Twin Tower, Tower B, 6th Floor, Golf Course Road, Sector 54, Gurgaon, Haryana. • 1 acre = 43560 Sq. Ft. • 1 Sq. Mtr. = 10,764 Sq. Ft.

Some of the information may give an impression of forward looking statements even though they are not meant or intended to be so and customers dealing with such information are required to undertake full and independent analysis thereof.

In no event will the Company be liable to the reader or any third party for any incidental, consequential, indirect, special, or exemplary damages, including, without limitation, loss of business, lost profits, business interruption, loss of business information or any pecuniary loss, arising out of, in connection with, or relating to the use or performance of the information based out of or contained herein.

The Company and any of its affiliates, subsidiaries, officers, directors, employees or agents provide the Brochure and the Information on an "as is" basis and do not make any express or implied warranties, representations, endorsements or conditions with respect to the Brochure or the Information, including without limitation, warranties as to merchantability, operation, non-infringement, usefulness, completeness, accuracy, current validity, reliability and fitness for a particular purpose.